



# KUEBLER - LIMES MAGNETIC SENSOR LI20 MAGNETIC TAPE B1 SERIE 8.B1



- Resolution up to 0.01 mm
- Contactless measuring technology
- Status LED
- IP67 Impervious to chips, oil, water, etc.



## PRODUCT DESCRIPTION

Linear sensor used to measure linear movements with high accuracy, for example in woodworking machines, lathes, material handling, overhead cranes etc. The sensor is almost entirely non-sensitive to chips, oil, dust and water and can thus be used in troublesome environments, it is sealed and has no moving parts. This sensor is fitted to read a magnetic tape with a self-adhesive underside. This sensor is available with different resolutions, and if the recipient (counter/PLC) has a multiplication function, a resolution of 10  $\mu\text{m}$  can be achieved. See electrical data (Resolution, Accuracy) for more information. Magnetic tape B1 has a polar distance of 2 mm. For the combination LI20/B1, the distance between sensor and tape must be 0.1 to 1.0 mm (0.4 mm is recommended). For the magnet sensor, the slope must not exceed  $\pm 3^\circ$ , the rotation must not exceed  $\pm 3^\circ$  and the offset must not exceed  $\pm 1$  mm.

The following information is required to select the right combination:

- requirement on accuracy (from 0.4 mm to 0.01 mm)
- the movement's speed (taking into account frequency to subsequent systems and the sensor's max. speed)
- the movement's length (to order the magnetic scale's length = required length of measurement + 1 dm)

Please refer to the images below for ordering information.

Order code sensor head Limes LI20		8.LI20 . X1X1 . 2XXX Type      a   b   c   d   e   f					
<b>a</b> Model 1 = IP67, standard 2 = IP68 / IP69k and humidity tested acc. to EN 60068-3-38, EN 60068-3-78	<b>c</b> Output circuit / power supply 1 = RS422 / 4.8 ... 26 V DC 2 = Push-pull / 4.8 ... 30 V DC	<b>e</b> Reference signal 2 = index periodic				Stock types 8.LI20.1111.2005 8.LI20.1111.2020 8.LI20.1111.2050 8.LI20.1121.2005 8.LI20.1121.2020 8.LI20.1121.2050	
<b>b</b> Pulse edge interval 1 = standard	<b>d</b> Type of connection 1 = cable, 2 m [6.56'] PUR	<b>f</b> Code (resolution) <sup>1)</sup> 005 = 100 µm 020 = 25 µm 050 = 10 µm					

Order code magnetic band Limes B1		8.B1 . 10 . 010 . XXXX Type      a   b   c   d			
<b>a</b> Width 10 = 10 mm	<b>b</b> Length 0010 = 1 m      0060 = 6 m 0020 = 2 m      0100 = 10 m 0040 = 4 m      0200 = 20 m 0050 = 5 m	Optional on request - other lengths up to 70 m		Stock types 8.B1.10.010.0010	

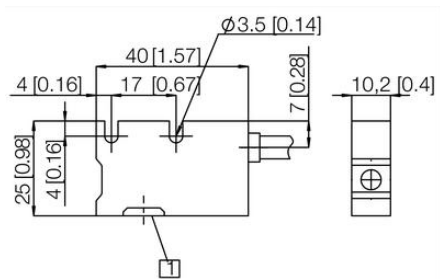

1 mätområde